



2018 CEO SYMPOSIUM



California Community Colleges

March 2-5, 2018

Seascape Hotel & Resort | Monterey Bay, CA



Community College League of California

Quality Public Community Colleges for All Californians

Schedule At-A-Glance

Friday, March 2

- 4:00 p.m. Symposium Check-In
- 5:30 p.m. Welcome Reception

Saturday, March 3

- 8:30 a.m. Breakfast Session or Breakfast-Only Option
- 9:30 a.m. General Sessions
- 12:30 p.m. CEO-Only Discussions
- 4:30 p.m. Networking
- 6:00 p.m. Reception on the Seascapes Bluff

Sunday, March 4

- 8:00 a.m. Breakfast Session or Breakfast-Only Option
- 9:00 a.m. General Sessions
- 3:30 p.m. Networking & Optional Self-Guided Tours
- 6:00 p.m. Reception
- 7:00 p.m. Retiree Recognition Dinner

Monday, March 5

- 8:00 a.m. CEO Funding Formula Workgroup Meeting
- 8:30 a.m. Breakfast & Networking Time

CEO Symposium Planning Committee

The League thanks the members of the 2018 CEO Symposium Planning Committee.

Special thanks to committee members Nabil Abu-Ghazaleh, Grossmont College; Gari Browning, Ohlone CCD; Jannett Jackson, Chabot-Las Positas CCD; Ron Galatolo, San Mateo CCD; Brian King, Chancellor, Los Rios CCD; Jill Stearns, Modesto Junior College; Kevin Walthers, Superintendent/ President, Allan Hancock CCD; Joe Wyse, Superintendent/President, Shasta-Tehama-Trinity CCD; and Wei Zhou, Crafton Hills College.

LCW LIEBERT CASSIDY WHITMORE



“An investment in knowledge pays the best interest.” - Benjamin Franklin

You serve others and LCW is honored to serve you.

*At LCW we are not solely lawyers. We are your trusted partners, working to find practical solutions to legal problems that support each client’s unique goals, challenges and vision. For **over 35 years**, we have been assisting California Community Colleges in the full array of issues you confront, including:*

Conflicts of Interest	Disability, Leaves, Rights, and Benefits	Facilities
Brown Act		Litigation
Public Records Act	EEO Hiring and Diversity	Administrator, Vendor, and Dual Enrollment Contracts
Campus Safety/Title IX/Clery Act	Labor Relations & Negotiations	Post-Election Issues
Employee Discipline	Student Rights & Discipline	Preventative Training

To learn how we can help your college, please visit:

WWW.LCWLEGAL.COM/EXPERTISE/PUBLIC-EDUCATION

Program

Friday, March 2

4:00 p.m. – 7:00 p.m. **Symposium Check-In**
2nd Floor Seascape Foyer

5:30 p.m. – 7:00 p.m. **Welcome Reception**
Sponsored by Atkinson, Andelson, Loya, Ruud & Romo

Bayview

Saturday, March 3

8:30 a.m. – 9:30 a.m. **Breakfast Session**
Peninsula

Legal Update from Liebert Cassidy Whitmore

Liebert Cassidy Whitmore will provide a high-level overview on current issues every community college CEO should know about. Specifically, it will address: AB 19; Employee orientation; AB 21 immigration/sanctuary; Guidance on new laws and legal advisories; Campus safety including the #metoo movement; and Part-time retiree rehire rights.

8:30 a.m. – 9:30 a.m. **Breakfast Session**
Palo Alto

Student Housing - Creating the Vision

The need for student housing has been part of a systemwide discussion for many years. While some colleges have embarked on this process, the numbers are too low to impact the need. The barriers individual colleges face are diverse but there is a common thread. This discussion will help identify those common threads to help drive a housing discussion forward.

8:30 a.m. – 9:30 a.m. **Breakfast-Only Option**
Seascape Ballroom

General Sessions | Seascape Ballroom

9:30 a.m. – 10:00 a.m. **Welcome & Introductions**

Brian King, Chancellor of the Los Rios Community College District and Chair of the CEOCCC will lead introductions of all attending CEOs.

Saturday, March 3 (cont'd)

10:00 a.m. – 11:30 a.m. Keynote

The Leadership Role in Community College Excellence **Josh Wyner, Founder/Executive Director of the College Excellence Program at the Aspen Institute**

After carefully studying the characteristics of dozens of the country's highest performing community colleges competing for the Aspen Prize for Community College Excellence, the College Excellence Program has identified a number of cross-cutting characteristics that make these institutions (and their leaders) capable of achieving high and rapidly improving levels of student success. Josh will explore Aspen's four-part definition of student success, the themes that characterize exceptional community colleges, and the role of leaders in advancing scaled and sustained student success reforms. He will further address how leadership will need to change as colleges are expected to move beyond the completion agenda and be responsible for their students' post-college success.

Panel of Respondents: Rufus Glasper, Mary Spilde, and Karen Stout

11:30 a.m. – 12:15 p.m. CEO Breakout Discussions

The Un-Democratization of Community College Governance and Finance *Facilitator:* Rufus Glasper, President/CEO, League for Innovation [Peninsula](#)

Economists have long argued that governing boards and states have a vested interest in supporting higher education institutions as essential economic contributors; however, this role is not currently being supported by elected officials. This trend and its impact on community college governance and finance suggests a transition to a less democratic political regime. What are the consequences of this disinvestment in colleges, students, and communities, including the growth of local economies?

Adaptive Leadership: The Role of Professional Development in Shifting Culture

Facilitator: Mary Spilde, President Emerita, Lane Community College
[Cypress Grove North](#)

Comprehensive professional development can be used strategically as an approach to change the climate and culture of a college. Using adaptive leadership as the cornerstone, explore the president's role in creating a four-pronged approach of internal leadership development, emotional intelligence, appreciative inquiry, and intentional onboarding of new faculty and staff. Participants will be invited to discuss strategies to develop organizational agility and build capacity to be change-ready.

Saturday, March 3 (cont'd)

Applying the Fundamentals and Characteristics of Excellence

Facilitator: Karen Stout, President and CEO of Achieve the Dream

Palo Alto

An institution of higher education is a community dedicated to the pursuit and dissemination of knowledge, to the study and clarification of values, and to the advancement of the society it serves. Discuss strategies that promote the values of excellence across all levels of a college.

12:15 p.m. – 1:00 p.m.

Networking Lunch

Riviera

Sponsored by Liebert Cassidy Whitmore

CEO-Only Sessions | Seascape Ballroom

1:00 p.m. – 3:30 p.m.

CEO Conversation: The Community College Funding Formula

Facilitator: Karen Stout, President and CEO of Achieve the Dream

3:30 p.m. – 4:30 p.m.

Preparing for Negotiations While Honoring Your Mission to Students

This panel from School Employers Association of California (SEAC) will discuss how to prepare for negotiations with your bargaining units and honor your mission to providing quality educational programs and services to students. The panel will discuss real life negotiations experiences and how to achieve the outcomes desired by the governing board of the districts. Hear about critical issues to address in bargaining and some issues to avoid.

Panel: Ed Knudson, Superintendent/President, Antelope Valley Community College District; Ruben L. Ingram, Executive Director, School Employers Association of California (SEAC); Louise Taylor, Assistant Executive Director, School Employers Association of California (SEAC)

Networking Time | 4:30-6:00 p.m.

6:00 p.m. – 7:30 p.m.

Reception on Seascape Bluff

Sponsored by the Foundation for California Community Colleges

Sunday, March 4

8:00 a.m. – 9:00 a.m. Breakfast Session

Peninsula

Enrollment Management Best Practices from a Board and CEO Perspective

AALRR will provide a practical guide to how CEO's can work together with their Board and their staff in the development and implementation of a comprehensive enrollment management plan covering data collection and analysis on student access, success and completion; policy development, and engagement of the faculty, as well as regional K-12 institutions, industry partners and community based organizations.

8:00 a.m. – 9:00 a.m. Breakfast Session

Palo Alto

Affordability, Engagement and the California Promise

During this presentation, Macmillan and Intellus will cover the growing importance of meeting students at their point of need – whether it is lowering cost, an active in-class experience, or dorm life. Addressing each student's individual needs help toward making the institution a more equitable environment and help more succeed. Hear about solutions designed to increase successful graduation, facilitate college affordability, develop more engaged learners.

8:00 a.m. – 9:00 a.m. Breakfast-Only Option

Seascape Ballroom

General Sessions | Seascape Ballroom

9:05 a.m. – 10:00 a.m. Keynote

Change Leadership and the CCC Vision for Success

Chancellor Eloy Ortiz Oakley

10:00 a.m. Coffee Break

Sponsored by WLC Architects

CEO-Only Sessions | Seascape Ballroom

10:15 a.m. – 12:00 p.m.

CEO Conversations: The California Online College

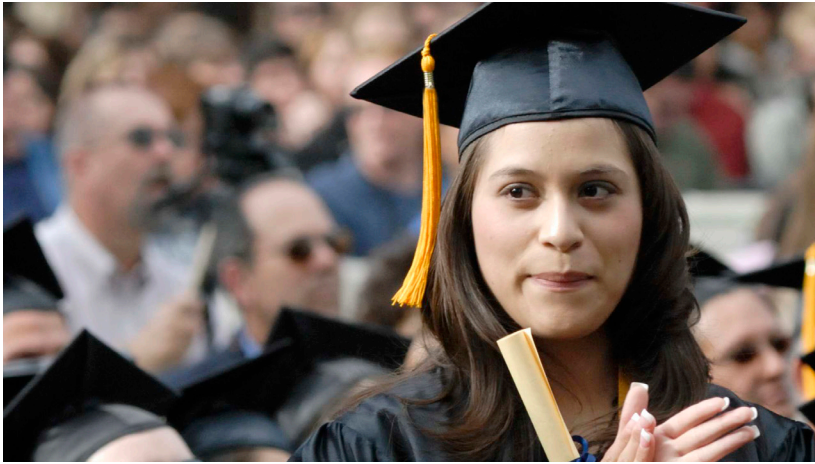

**STUDENT
SUCCESS**



**WORKFORCE
DEVELOPMENT**

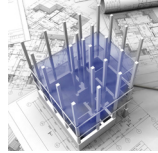

EQUITY



**COMMUNITY
IMPACT**



**SYSTEM
SUPPORT AND
SERVICES**

Celebrating 20 years of benefiting, supporting, and enhancing the California Community Colleges.



Our work helps to benefit all California Community College students, colleges, college foundations, and the system as a whole by strengthening communities, accelerating paths to economic and social mobility, and reducing barriers to opportunity for all Californians.



FOUNDATION *for* CALIFORNIA
COMMUNITY COLLEGES

www.foundationccc.org

Sunday, March 4 (cont'd)

12:00 p.m. – 12:50 p.m. Lunch and Networking

Sponsored by Macmillan/Intellus

Riviera

CEO-Only Sessions | Seascape Ballroom

1:00 p.m. – 2:30 p.m. CEO Discussions

CEO Roles in Addressing Race, Class and Equity

Facilitators: Byron Breland; Keith Curry; Pam Luster; Kevin Walthers; Thuy Nguyen; Diana Rodriguez

Join in colleagues from across the state in meaningful and productive conversation on the CEO role in addressing Race, Class and Equity.

- Understand the impact of inequity on our society;
- Understand how college completion impacts economic futures;
- Understand what inequity looks like on college campuses;
- Gain an understanding of the concept of equity mindedness;
- Evaluate the factors of equity mindedness on each campus; and,
- Develop specific ideas to take back to campus to support equity initiatives.

Networking Time | 2:30-6:00 p.m.

Self-Guided Tour Options

Affiliated with Seascape Resort:

Bike Rental (\$10/hour per bike)

Sightseeing:

Shuttle to Beach Boardwalk or Capitola

Wine Tasting (20 minutes from Seascape Resort):

Nicholson Vineyards

Alfaro Family Vineyards and Winery

3:00 p.m. – 4:30 p.m. CEO Academy Planning Committee

Palo Alto

Sunday, March 4 (cont'd)

6:00 p.m. – 7:00 p.m. Retiree Reception
Riviera Foyer *Sponsored by Liebert Cassidy Whitmore*

7:00 p.m. – 9:00 p.m. Retiree Recognition Dinner
Riviera

2018 Honorees

Stan Carrizosa, College of the Sequoias

Angela Fairchilds, Columbia College

Victor Jaime, Imperial Valley College

Laurel Jones, Cabrillo College

Renee Martinez, LA City College

Gil Stork, Cuesta College/San Luis Obispo CCD

Rajen Vurdien, Pasadena City College

Monday, March 5

8:00 a.m. – 10:00 a.m. CEO Funding Formula Workgroup
Palo Alto

8:30 a.m. – 9:30 a.m. Closing Networking Breakfast
Seascape

Thank You for attending the 2018 CEO Symposium!



macmillan
learning

Institutional Solutions for a Better World

Macmillan Learning's institutional solutions are designed to engage learners, make college more affordable, provide actionable insights into student success, and increase graduation rates.

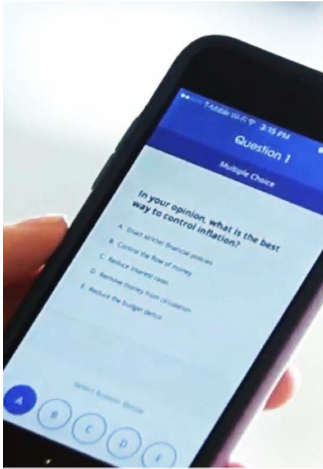

 **iClicker**
Active learning simplified



 **intellus**
LEARNING



 **skyfactor**

iClicker's market-leading student response solutions allow students to participate using laptops, mobile devices, or iClicker remotes--all in the same classroom. See why thousands of instructors use our simple, award-winning student response solutions to engage their students.

Reduce student costs with high-quality OER and academic library materials with **Intellus Learning**. And now, **Intellus Open Courses** make scaling OER initiatives even easier with its pre-built courses. Faculty and administrators also receive powerful, real-time insight into students' engagement with assigned content.

Skyfactor provides a proven, research-based student retention and success system, as well as easy-to-implement, standards-aligned assessments for Teacher Education, Business, Nursing Education, and Engineering programs and Student Affairs.

Three
years in
a row!



Learn more at <http://go.macmillanlearning.com/institutional.html>



CLIENT FOCUSED.
PASSION DRIVEN.

www.wlccarchitects.com

SOUTHERN CALIFORNIA
909.987.0909

BAY AREA
510.450.1999

SACRAMENTO
916.355.9922

SAN DIEGO
760.607.3400

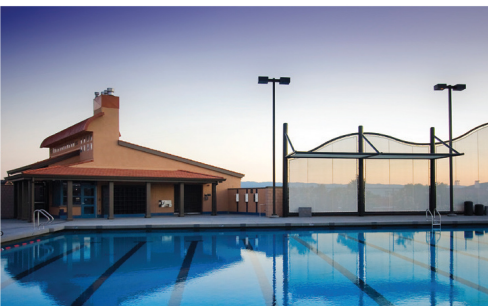

2018 Sponsors

Thank you to the sponsors of the CEO Symposium!

Platinum Sponsors



FOUNDATION *for* CALIFORNIA
COMMUNITY COLLEGES



Gold Sponsors



Community College League of California

Quality Public Community Colleges for All Californians